

DIMENSIONAL SPECIFICATIONS

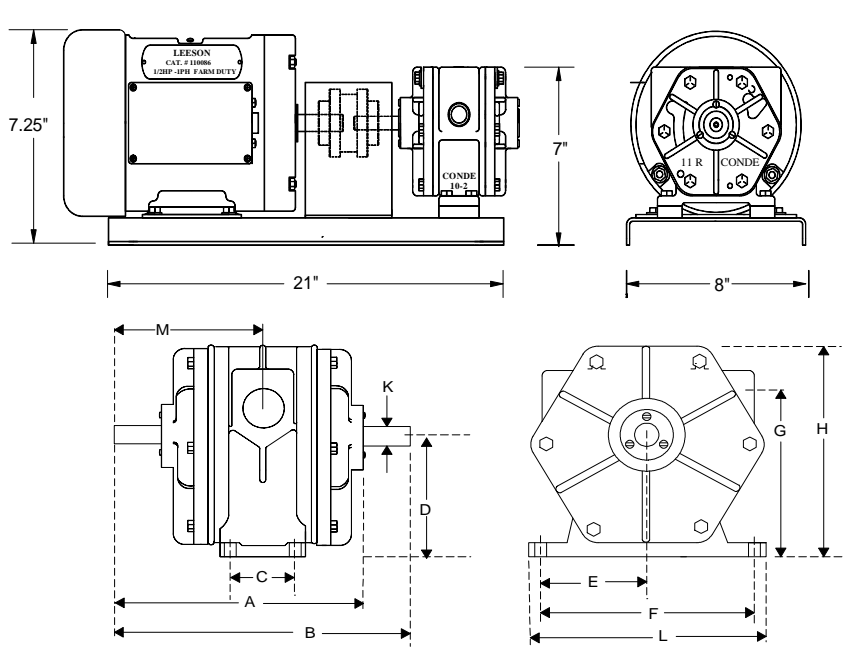

INCHES

A	6.875
B	8.5
C	1.0
D	3.375
E	2.0625
F	4.125
G	3.375
H	5.25
K	.5
L	5.0
M	2.625

TECHNICAL SPECIFICATIONS

* **MAXIMUM AIR FLOW (Vac.)**
7 Cubic Feet per minute @ free air

* **HORSEPOWER REQUIREMENTS**
1/3 hp to 1/2 hp

* **SPEED RANGE**
1100 RPM to 1750 RPM

* **MAXIMUM PRESSURE**
15 PSI Intermittent, 10 PSI Continuous

* **WEIGHT**
13 LBS. (Pump Only)

* **PORT SIZE**
1/2 Inch NPT

* **MAXIMUM VACUUM**
24" Hg Intermittent, 20" Hg Continuous

* **SHAFT DIAMETER**
1/2 Inch

Options

- * Relief Valve
- * Inlet and Outlet Filters
- * Mechanical Seals
- * Single or Three Phase Motors
- * Direct Drive or Belt Drive

PERFORMANCE SPECIFICATIONS

VACUUM

In. Hg	1200 RPM		1350 RPM		1500 RPM		1750 RPM	
	CFM	HP	CFM	HP	CFM	HP	CFM	HP
2	4.9	1/3	5.0	1/3	5.3	1/3	6.2	1/3
4	4.2	1/3	4.3	1/3	4.8	1/3	5.4	1/3
6	3.1	1/3	4.0	1/3	4.3	1/3	4.9	1/3
8	2.8	1/3	3.7	1/3	4.0	1/3	4.5	1/3
10	2.6	1/3	3.0	1/3	3.5	1/3	4.0	1/3
12	2.5	1/3	2.6	1/3	3.1	1/3	3.5	1/3
14	1.9	1/3	2.2	1/3	2.7	1/3	3.1	1/3
16			1.9	1/3	2.3	1/3	2.6	1/3
18							2.1	1/3
20							1.7	1/2
22							1.0	1/2

PRESSURE

PSIG	1200 RPM		1350 RPM		1500 RPM		1750 RPM	
	CFM	HP	CFM	HP	CFM	HP	CFM	HP
2	4.7	1/3	4.9	1/3	5.6	1/3	6.0	1/3
4	4.2	1/3	4.4	1/3	5.0	1/3	5.5	1/3
6	3.5	1/3	3.7	1/3	3.9	1/3	5.4	1/3
8	3.0	1/3	3.2	1/3	3.5	1/3	5.3	1/3
10	2.7	1/3	2.7	1/3	3.0	1/3	4.6	1/3

906 West Hamilton Avenue
Sherrill, New York 13461

Phone: 800-367-0972

Fax: 315-363-0193

Visit us on the world wide web at:

www.westmoorltd.com

Conde' Pumps



Model 3

Dry Air Vacuum Pump



INCHES

A	8.25
B	10.0
C	2.25
D	4.36
E	3.125
F	6.25
G	5.25
H	7.5
K	.75
L	7.0
M	5.0

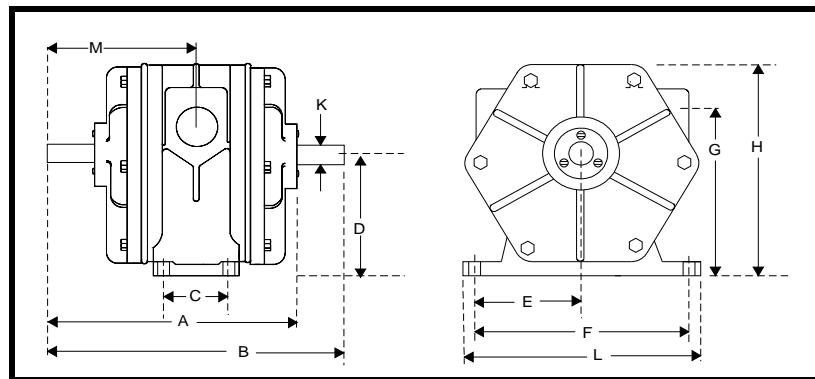

* **Versatile Shaft Designs**

Clockwise, Counter Clockwise or Double Shaft to fit any installation need.

* **Provides Clean Pulse Free Air For Vacuum and Pressure Applications**

* **Virtually Maintenance Free Operation**

* **Available In A Variety Of Pump/Motor Packages To Tailor Your Air Flow Needs With Horsepower Requirements**

* **Units Complete With Filters, Check Valve And Relief Vavles**

* **Gastite Model Available For Leak Free Operation**

* **Ideal Vacuum Applications Up To 20" Hg Continuous Operation, 24" Hg Intermittent, Or Pressures Up To 10 PSIG Continuous, 15 PSI Intermittent**

DIMENSIONAL SPECIFICATIONS

Model 3

Direct Drive Dimensions

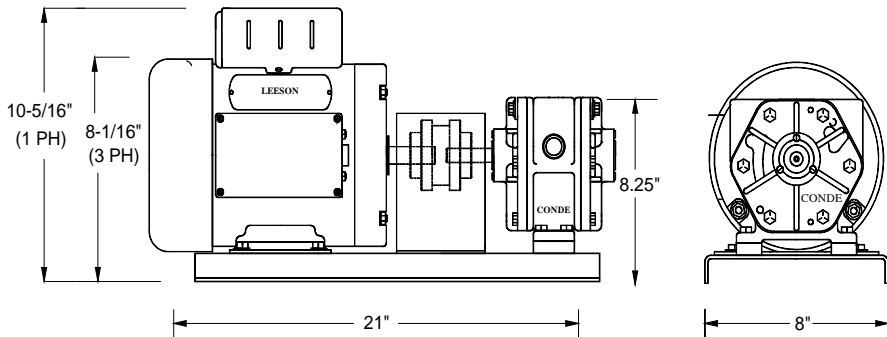

Belt Drive Dimensions

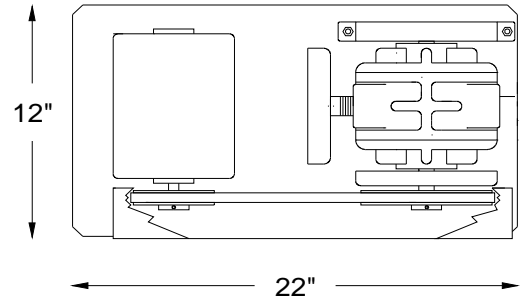

TECHNICAL SPECIFICATIONS

*** MAXIMUM AIR FLOW (Vac.)**

20 Cubic Feet per minute @ free air RPM

*** HORSEPOWER REQUIREMENTS**

1/3 hp to 2 hp

*** SPEED RANGE**

1100 RPM to 1750

*** MAXIMUM PRESSURE**

15 PSI Intermittent, 10 PSI Continuous

*** WEIGHT**

35 LBS. (Pump Only)

*** PORT SIZE**

3/4 Inch NPT

*** MAXIMUM VACUUM**

***SHAFT DIAMETER**

Options

- * Relief Valve
- * Inlet and Outlet Filters
- * Mechanical Seals
- * Single or Three Phase Motors
- * Direct Drive or Belt Drive

PERFORMANCE SPECIFICATIONS

VACUUM

In. Hg	1200 RPM		1350 RPM		1500 RPM		1750 RPM	
	CFM	HP	CFM	HP	CFM	HP	CFM	HP
2	13.0	1/3	14.6	1/2	15.9	3/4	17.7	3/4
4	11.9	1/2	13.7	3/4	14.8	3/4	16.5	1
6	10.9	1/2	12.6	3/4	13.5	3/4	15.2	1
8	10.0	3/4	11.4	3/4	12.4	1	13.9	1
10	9.0	3/4	10.2	1	11.0	1	12.7	1
12	7.9	3/4	9.1	1	9.7	1	11.1	1-1/2
14	7.0	1	7.8	1-1/2	8.5	1-1/2	9.6	1-1/2
16	6.2	1	6.8	1-1/2	7.4	1-1/2	8.4	1-1/2
18	5.1	1	5.5	1-1/2	6.1	1-1/2	6.9	1-1/2
20			4.1	1-1/2	4.8	1-1/2	4.4	1-1/2
22					3.4	1-1/2	4.0	1-1/2
24					2.4	1-1/2	2.8	2

PRESSURE

PSIG	1200 RPM		1350 RPM		1500 RPM		1750 RPM	
	CFM	HP	CFM	HP	CFM	HP	CFM	HP
2	13.9	1/2	15.1	3/4	17.1	1/3	19.3	1
4	13.0	3/4	14.5	3/4	16.5	1/3	18.9	1
6	11.4	3/4	13.7	1	15.6	1/3	17.8	1-1/2
8	10.4	3/4	12.6	1-1/2	15.1	1/3	17.4	2
10	8.4	1	11.4	1-1/2	14.1	1/3	16.4	2
12					13.2	2	15.6	2

906 West Hamilton Avenue
Sherrill, New York 13461

Phone: 800-367-0972

Fax: 315-363-0193

Conde' Pumps

Visit us on the world wide web at:

www.westmoorltd.com



Model 6

Dry Air Vacuum Pump

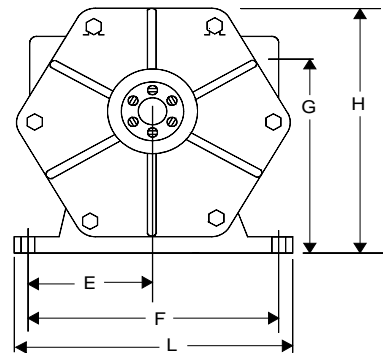
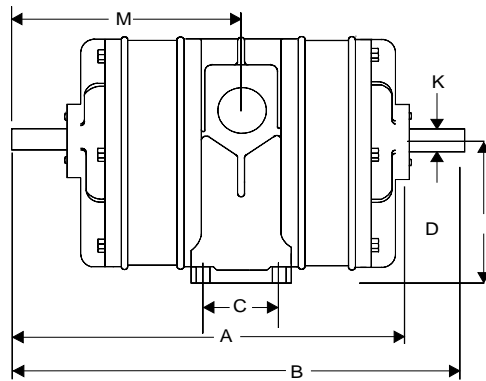

INCHES

A	13.56
B	16.50
C	2.25
D	4.36
E	3.125
F	6.25
G	5.25
H	7.38
K	1.0
L	7.0
M	8.25

* **Versatile Shaft Designs**

Clockwise, Counter Clockwise or Double Shaft to fit any installation need.

* **Provides Clean Pulse Free Air For Vacuum and Pressure Applications**

* **Virtually Maintenance Free Operation**

* **Available In A Variety Of Pump/Motor Packages To Tailor Your Air Flow Needs With Horsepower Requirements**

* **Units Complete With Filters, Check Valve And Relief Vavles**

* **Gastite Model Available For Leak Free Operation**

* **Ideal Vacuum Applications Up To 20" Hg Continuous Operation, 24" Hg Intermittent, Or Pressures Up To 10 PSIG Continuous, 15 PSI Intermittent**

DIMENSIONAL SPECIFICATIONS

Direct Drive Dimensions

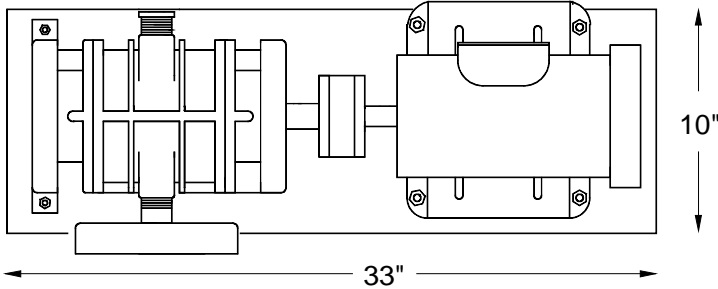

Belt Drive Dimensions

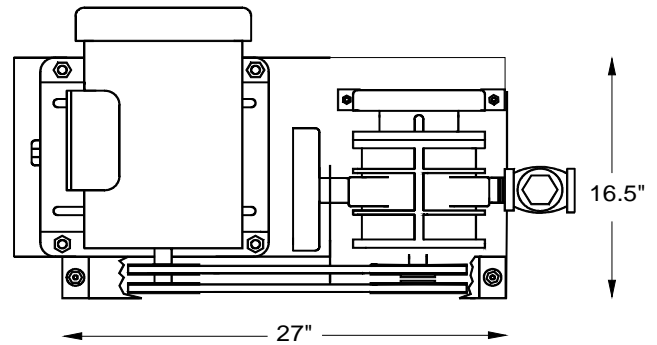

TECHNICAL SPECIFICATIONS

* **MAXIMUM AIR FLOW (Vac.)**
40 Cubic Feet per minute @ free air

* **HORSEPOWER REQUIREMENTS**
1/2 hp to 7.5 hp

* **SPEED RANGE**
1100 RPM to 1750 RPM

* **MAXIMUM PRESSURE**
15 PSI Intermittent, 10 PSI Continuous

* **WEIGHT**
60 LBS. (Pump Only)

* **PORT SIZE**
1 Inch NPT

* **MAXIMUM VACUUM**
24" Hg Intermittent, 20" Hg Continuous

* **SHAFT DIAMETER**
1 Inch

Options

- * Relief Valve
- * Inlet and Outlet Filters
- * Mechanical Seals
- * Single or Three Phase Motors
- * Direct Drive or Belt Drive

PERFORMANCE SPECIFICATIONS

VACUUM

In. Hg	1200 RPM		1350 RPM		1500 RPM		1750 RPM	
	CFM	HP	CFM	HP	CFM	HP	CFM	HP
2	24.0	1/3	27.0	1-1/2	30.0	2	35.0	2
4	23.1	1/2	25.9	1-1/2	28.5	2	32.3	2
6	21.5	1/2	23.9	1-1/2	26.6	2	29.8	2
8	19.8	3/4	21.8	1-1/2	24.6	2	27.3	3
10	17.8	3/4	19.9	2	22.1	3	24.7	3
12	15.8	3/4	17.9	2	19.5	3	22.0	3
14	14.0	1	15.5	3	17.2	3	19.0	3
16	12.2	1	13.0	3	14.8	3	16.0	5
18	9.9	1	26.5	3	12.3	3	13.5	5
20	7.6	1-1/2	9.1	3	9.8	3	10.9	5
22	5.5	1-1/2	6.9	3	7.4	5	8.1	5
24	3.4	1-1/2	4.7	3	4.9	5	5.3	5

PRESSURE

PSIG	1200 RPM		1350 RPM		1500 RPM		1750 RPM	
	CFM	HP	CFM	HP	CFM	HP	CFM	HP
2	24.8	1-1/2	29.2	1-1/2	32.8	2	37.4	3
4	24.0	1-1/2	28.4	2	32.0	3	36.8	3
6	22.8	2	27.5	3	31.2	3	36.1	5
8	22.2	3	26.5	3	30.2	3	35.0	5
10	20.0	3	25.5	3	29.5	3	34.0	5
12	19.4	3	25.2	3	28.6	5	33.2	5
14					28.0	5	31.8	7-1/2
16						5	30.0	7-1/2

906 West Hamilton Avenue
Sherrill, New York 13461

Conde' Pumps

Phone: 800-367-0972

Fax: 315-363-0193



Model 12

Dry Air Vacuum Pump

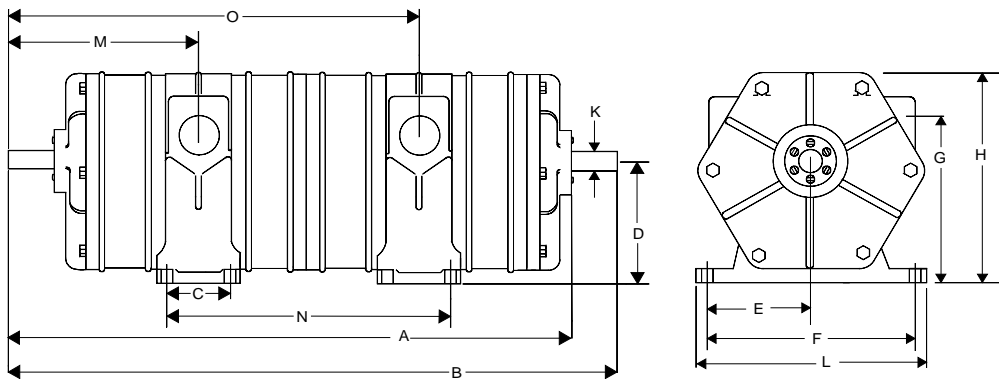

INCHES

A	20.00
B	22.50
C	2.25
D	4.36
E	3.125
F	6.25
G	5.25
H	7.38
K	1.0
L	7.0
M	8.25
N	8.50
O	14.25

*** Versatile Shaft Designs**

Clockwise, Counter Clockwise or Double Shaft to fit any installation need.

*** Provides Clean Pulse Free Air For Vacuum and Pressure Applications**

*** Virtually Maintenance Free Operation**

*** Available In A Variety Of Pump/Motor Packages To Tailor Your Air Flow Needs With Horsepower Requirements**

*** Units Complete With Filters, Check Valve And Relief Vavles**

*** Gastite Model Available For Leak Free Operation**

*** Ideal Vacuum Applications Up To 20" Hg Continuous Operation, 24" Hg Intermittent, Or Pressures Up To 10 PSIG Continuous, 15 PSI Intermittent**

DIMENSIONAL SPECIFICATIONS

Model 12

Direct Drive Dimensions

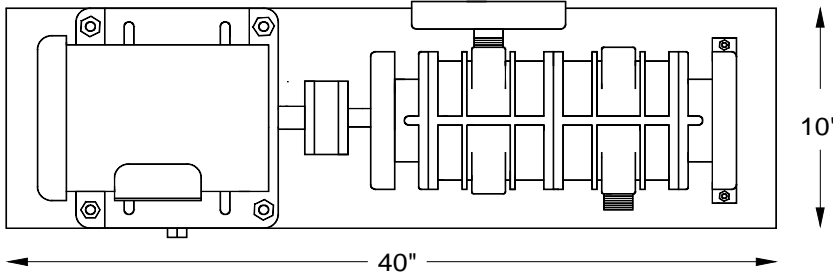

Belt Drive Dimensions

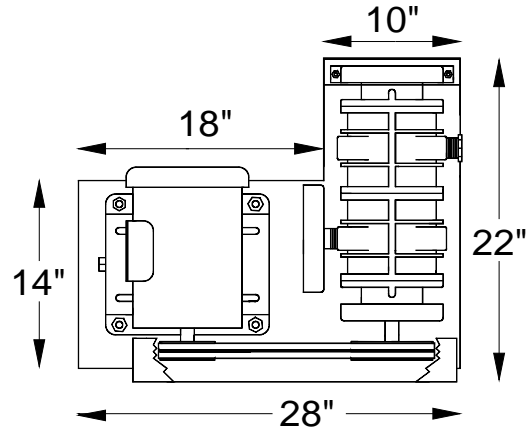

TECHNICAL SPECIFICATIONS

* **MAXIMUM AIR FLOW (Vac.)**
70 Cubic Feet per minute @ free air

* **HORSEPOWER REQUIREMENTS**
3 hp to 15 hp

* **SPEED RANGE**
1100 RPM to 1750 RPM

* **MAXIMUM PRESSURE**
15 PSI Intermittent, 10 PSI Continuous
NPT

* **WEIGHT**
100 LBS. (Pump Only)

* **PORT SIZE**
1-1/4 Inch

* **MAXIMUM VACUUM**

* **SHAFT DIAMETER**

Options

- * Relief Valve
- * Inlet and Outlet Filters
- * Mechanical Seals
- * Single or Three Phase Motors
- * Direct Drive or Belt Drive

PERFORMANCE SPECIFICATIONS

VACUUM

In. Hg	1200 RPM		1350 RPM		1500 RPM		1750 RPM	
	CFM	HP	CFM	HP	CFM	HP	CFM	HP
2	47.0	2	52.0	3	57.0	5	63.0	5
4	43.0	2	48.0	3	52.0	5	58.0	5
6	39.0	3	44.0	3	48.5	5	54.0	5
8	35.0	3	40.0	3	45.0	5	50.0	5
10	32.0	3	36.5	5	40.5	5	45.5	7.5
12	29.0	3	33.0	5	36.0	5	41.0	7.55
14	25.5	5	28.5	5	31.0	5	35.5	7.5
16	22.0	5	24.0	5	26.0	5	30.0	7.5
18	18.0	5	20.5	5	22.0	7.5	24.5	7.5
20	14.0	5	17.0	5	18.0	7.5	19.0	7.5
22	10.0	5	12.5	7.5	13.5	7.5	14.5	7.5
24	6.0	5	8.0	7.5	9.0	7.5	10.0	10

PRESSURE

PSIG	1200 RPM		1350 RPM		1500 RPM		1750 RPM	
	CFM	HP	CFM	HP	CFM	HP	CFM	HP
2	46.0	3	55.0	5	60.0	5	70.0	5
4	45.0	3	54.0	5	59.0	5	68.0	7.5
6	42.0	5	52.0	5	58.0	5	66.0	7.5
8	40.0	5	50.0	5	57.0	7.5	65.0	10
10	39.0	5	48.0	7.5	56.0	7.5	64.0	10
12	35.0	5	46.0	7.5	54.0	7.5	62.0	10
14					50.0	7.5	58.0	15
16						7.5	54.0	15

906 West Hamilton Avenue
Sherrill, New York 13461



Phone: 800-367-0972

Fax: 315-363-0193